

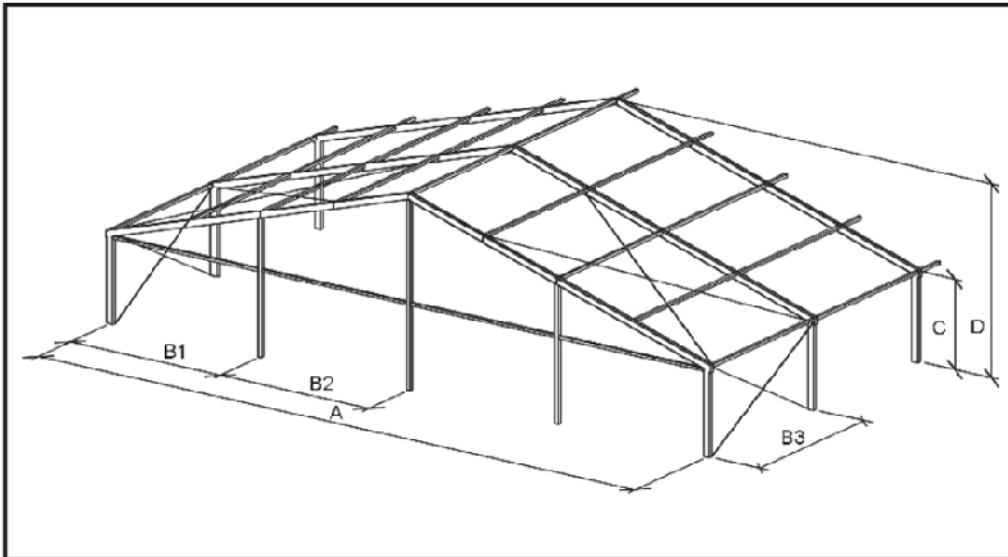

## Uniflex - Party and Exhibition Hall Type 20.14/300



### System Measures

Width	(A)	20.14 m
Eave height	(C)	3.00 m
Ridge height	(D)	6.30 m
Gable truss	(B1)	5.07 m
Gable truss	(B2)	5.00 m
Truss-distance	(B3)	5.00 m
Roof Slope		18°
Longest component		8.50 m
Truss profile		200 x 120 mm

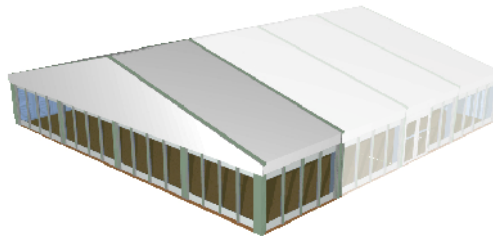

### Technical Description

#### Aluminium Profiles

Solid, hard pressed  
4-groove aluminium hollow profile

#### Steel parts:

hot-dip galvanized according to DIN EN ISO 1461

#### Ground Anchoring

Ground stakes or weight anchoring upon request

### Load Requirements/Technical Data

Wind load acc. to DIN 4112  
Min. length 10m.  
Max. length unlimited in truss distance